

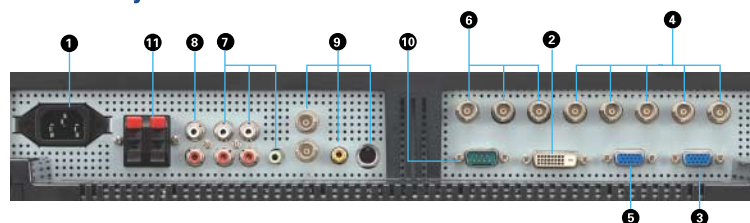

Connectivity



- ① **AC IN Connector**
Connects with a power cord.
- ② **RGB 1 IN (DVI-D)**
To input digital RGB signals from a computer.
* This connector does not support analog input.
- ③ **RGB 2 IN (mini D-Sub 15 pin)**
To input analog RGB signals from a computer or other RGB equipment.
- ④ **RGB 3 IN (R, G, B, H, V) (BNC)**
To input analog RGB signals from a computer or other RGB equipment.
- ⑤ **VIDEO IN/OUT**
VIDEO IN connector (BNC and RCA): To input composite video signal. BNC and RCA are not available to be used at the same time.
VIDEO OUT connector (BNC): To output composite video signal from VIDEO IN connector.
S-VIDEO IN connector (DIN 4 pin): To input S-video (Y/C separate signal).
EXTERNAL CONTROL (mini D-Sub 9 pin)
Use when operating the LCD monitor from RGB equipment like a computer.
EXTERNAL SPEAKER TERMINAL
To output audio signal from AUDIO 1, 2 or 3 jack.
- ⑥ **RGB OUT (mini D-Sub 15 pin)**
To output the signal from RGB 2 IN or 3 IN.
- ⑦ **DVD/HD IN (BNC)**
Connecting equipment such as DVD player, HDTV device, or Laser disc player.
- ⑧ **AUDIO IN 1, 2, 3**
To input audio signal from external equipment such as a computer, VCR or DVD player.
- ⑨ **AUDIO OUT**
To output audio signal from the AUDIO IN 1, 2 and 3 jack.

Optional Stereo Speakers

High quality stereo speakers featuring 7W+7W output are available as an additional option.



Specifications

Item	LDT321V		LDT371V		
	Analog input	Digital input	Analog input	Digital input	
LCD module	TFT active matrix, 32"(800mm) diagonal		TFT active matrix, 37" (940mm) diagonal		
	0,511mm (H) x 0,511mm (V)		0,600mm (H) x 0,600mm (V)		
	Pixel pitch		1366 x 768 dots (WXGA)		
	Resolution		16.7 Million		
	Colour		500cd/m ²		
	Brightness(typ.)		1200:1		
Contrast ratio(typ.)		Up 88° / Down 88° / Left 88° / Right 88° (CR≥10)			
Viewing angle(typ.)		12ms(GTG: 6ms)			
Response time (typ.)		31.5 - 91.1kHz (Analog/Digital)			
Frequency	Horizontal		50.0/58.0 - 85.0Hz (Analog/Digital)		
	Vertical		13.5 - 165.0MHz		
Pixel clock	13.5 - 165.0MHz	25.0 - 165.0MHz	13.5 - 165.0MHz	25.0 - 165.0MHz	
Viewable size	698mm x 392mm / 27.5" x 15.4"		820mm x 461mm / 32.3" x 18.1"		
Power management	Yes / VESA DPM				
Plug and play	Yes / VESA DDC2B, DDC / CI				
Auto adjustment	Yes (Contrast / Position / Phase / Clock)				
OSD user function	Brightness, Contrast, Black level, Zoom, PIP, Screen saver, Side border colour, Gamma selection, Black level expansion, Heat status, Power ON delay, Schedule, Tiling, etc.				
Speaker / Audio output	External speaker jack 7W+7W 8 ohm				
Input / Output signal	PC input/Output				
	Analog video input / Output level	Analog RGB: 0.7V p-p Input impedance 75 ohm	TMDS (with HDCP)	Analog RGB: 0.7V p-p Input impedance 75 ohm	TMDS (with HDCP)
	Sync. input / Output level	Separate: TTL level (Posi / Negal) 2.2k ohm terminated	-	Separate: TTL level (Posi / Negal) 2.2k ohm terminated	-
	Input connectors	BNC (R, G, B, H, V) Mini D-SUB 15pin	DVI-D (Digital)	BNC (R, G, B, H, V) Mini D-SUB 15pin	DVI-D (Digital)
	Output connector	Mini D-SUB 15pin	-	Mini D-SUB 15pin	-
	Video input	Composite 1.0V p-p input impedance 75 ohm BNC and RCA input (Exclusive)			
Video output	Y / C / Y: 1.0Vp-p C: 0.3Vp-p input impedance 75 ohm S-Terminal-input				
	Component 1.0/0.7V p-p input impedance 75 ohm BNC input (HDTV: 50 / 60Hz)				
	Composite 1.0V p-p Input impedance 75 ohm BNC Output				
	RCA pin jack L / R x 2, Stereo mini jack x 1				
Audio input	RCA pin jack L / R x 1				
Audio line output	RCA pin jack L / R x 1				
Control input	Mini D-SUB 9pin (RS-232C)				
Power supply	Universal(AC100 - 240V)				
Operational environment	Current rating		2.1A @ 100 - 120V, 0.9A @ 220 - 240V		
	Temperature	1.6A @ 100 - 120V, 0.67A @ 220 - 240V		5 to 40°C / 41 to 104°F	
Storage environment	Humidity	20 - 80% (without condensation)			
	Temperature	-20 to 60°C / -4 to 140°F *For longer life usage of LCD monitor, operation 25°C / 77°F at ambient temperature is recommended.			
Dimension	Humidity	10 - 90% (without condensation), 90-3.5 x (Temp -40°C) % regarding over 40°C / 104°F			
	Net with stand	789mm (W) x 535mm (H) x 246mm (D) / 31.1"(W) x 21.1"(H) x 9.7"(D)	909mm (W) x 605mm (H) x 246mm(D) / 35.8" (W) x 23.8" (H) x 9.7" (D)		
	Net without stand	789mm (W) x 476mm (H) x 133mm (D) / 31.1"(W) x 18.8"(H) x 5.2"(D)	909 mm(W) x 546mm (H) x 133mm (D) / 35.8" (W) x 21.5" (H) x 5.3" (D)		
Weight	Gross	1045mm(W) x 710mm(H) x 346mm(D) / 41.1" (W) x 28.0" (H) x 13.6" (D)			
	Net	Approx. 18kg / 39lbs (with stand) Approx. 16kg / 36lbs (without stand)	Approx. 22kg / 49lbs (with stand) Approx. 20kg / 44lbs (without stand)		
	Gross	24kg / 52lbs			
VESA compatible arm mounting interface	12 Holes (100mm / 3.9" pitches)				
Complied regulatory and guidelines	UL60950-1 / C-UL / TUV-GS / EN60950-1 / BSMI / PSB / FCC-B / DOC-B / EN55022-B / EN55024 / EN61000-3-2 / EN61000-3-3 / C-Tick / RoHS / CE / GOST / US Mercury / CCC only for Chinese model				
Accessories	Power Cord, VGA (Mini-Dsub15p) Cable, User's Manual, Wireless Remote Controller, AAA Battery x 2, Clamper x 2, Screw for Clamper x 2, Main switch cover, Screw for Main Switch Cover x 2, Cable Holder				

Please use a power cord that matches with the AC voltage of power outlet and complies with the safety standard of your particular country. ●LCD panels are manufactured using high precision technology; nevertheless there may be some missing pixels and some pixels might be always lit or ●Displaying still pictures for long term may cause permanent image sticking. ●If you alter the original images either through compression or enlargement or something else, and show it on a display with commercial purpose or intention of showing to general public, it may infringe the copyright of the author which is protected by the copyright law. ●As a conversion adapter may be required to connect to Macintosh, check the configuration of the Macintosh connector beforehand. No conversion adapter is required for the models with Mini D-SUB 15pin VGA connector. ●Windows® is a registered trademark of Microsoft Corporation of US in the territory of US and others. ●Macintosh is a registered mark of Apple Computer US in the territory of US and others. ●Other company and product names are a registered mark or trademark of the relative company.



TOKYO BLDG., 2-7-3, MARUNOUCHI, CHIYODA-KU, TOKYO 100-8310 JAPAN
http://Global.MitsubishiElectric.com/

32" & 37" LCD Display from Mitsubishi

Ideal for business and retail applications

LDT321V & LDT371V





LCD Display
LDT37IV [37" screen]

Brightness	500 cd/m ²
Contrast ratio	1200:1
Viewing angle	176°(Hor.) / 176°(Vert.) (CR≥10)
Response Time	6ms (GTG)
Resolution	1366 x 768 (WXGA)

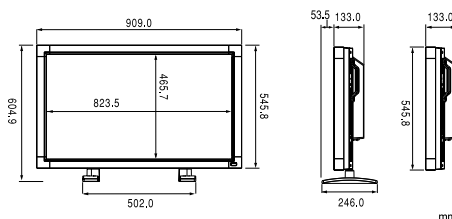

LCD Display
LDT32IV [32" screen]

Brightness	500 cd/m ²
Contrast ratio	1200:1
Viewing angle	176°(Hor.) / 176°(Vert.) (CR≥10)
Response Time	6ms (GTG)
Resolution	1366 x 768 (WXGA)

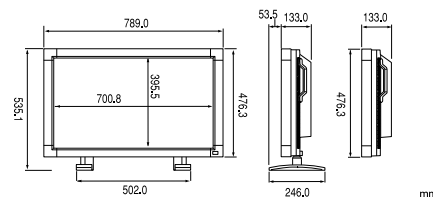

WXGA Resolution

The native resolution of 1366x768 (WXGA) enable to display precise high-definition images as well as PC output image. In addition, LDT series support wide range of PC and Video signals.

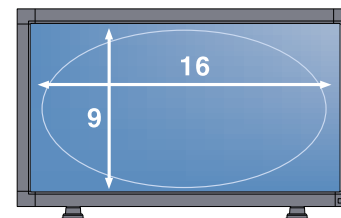

PC Input(Analog/Digital)

Horizontal Frequency Range	31.5kHz-91.1kHz
Vertical Frequency Range	50.0/58.0Hz-85.0Hz
Resolution	VGA / SVGA / XGA / WXGA / SXGA / UXGA (SXGA/UXGA: compressed/Simplified)
Video Input	
Video Signal	NTSC / 4.43NTSC / PAL / PAL-60 / SECAM
Component Signal	480i / 480p / 576i / 576p / 720p / 1080i

Fast Response Time and High Contrast

Features fast 6ms* response time for reproducing clear moving-pictures. Also high contrast ratio of 1200:1 and 500cd/m² high brightness ensures clear and crisp picture quality.

*Gray to Gray

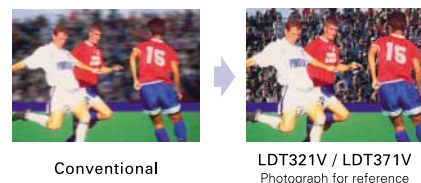

Wide Viewing Angle

The model carries wide viewing angle of 176° in both horizontal and vertical direction. Also minimizing color-shift from sideway viewing. Suitable for large audience viewing.

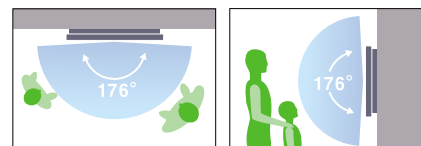

Low Light-Reflection

LCD screen has clear benefit against light-reflection in bright room environment. It can show important messages and pictures clearly.

Scheduling Function

Scheduling Function automatically switches your display ON and OFF. By entering ON/OFF date/time per input signals. Can preset upto 7 programs.



Tiling and Frame Comp

Tiling can simply set up multi-screen upto 16(4X4) screens, through OSD menu. Using Frame Comp, can adjust total screen image as a window view.

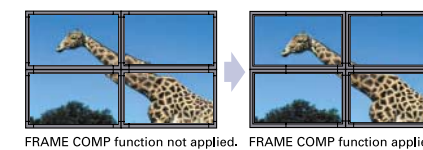

Picture In / Picture Out

Connected two signals can be displayed on one screen.

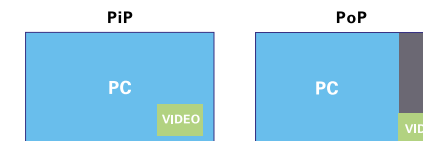

Zoom Mode

Screen image can be adjusted by Zoom function. Selectable from Full, Normal, Dynamic and Custom

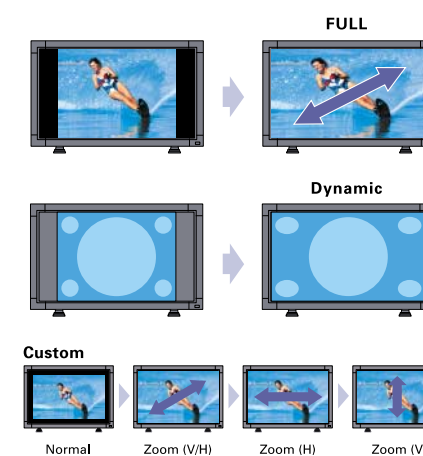

Side Border Color Select

When 4:3 screen is displayed, side border color can be selected from Black, Gray and White.



Screen Saver Function

Screen Saver Function is useful to expand lifetime of LCD panel under long term operation.



Gamma For selecting optimum Gamma to reduce risk of image-sticking.

Cooling Fan "ON" to run constantly. "AUTO" to run only when the monitor temperature increases to a certain level.

Brightness Limiting maximum brightness to half level.

Motion Motion Function slightly moves the picture (vertical and horizontal) with selected time period.

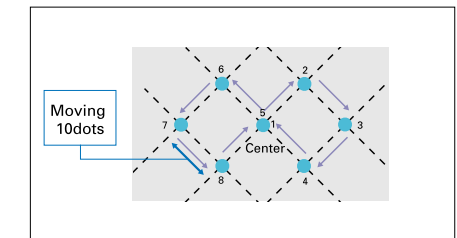

Self Diagnosis & Monitor Control

Enable to detect the failure items through RS-232C and DDC-CI. Also remotely control the setting of display through RS-232C.



Items for self diagnosis

- Temperature of inside cabinet
- Status of input signal
- Cooling fan failure

*NOTE: Controller Software is not included. Software need to be made by system supplier.

Power On Delay

Feeding power to multiple displays at once, may cause over-current problem. Power-On-Delay function enable to set the timing of Power-On through OSD menu to avoid over-current.

Heat Status

Inside temperature of display can be checked within OSD screen. When cooling fan is selected as "AUTO", Fan will run when the temperature reaches a certain level.

